



COST COMPARISON

EnergyEdge VS
TRADITIONAL EDGE & ALTERNATIVE EDGE INSULATION DETAILS

See Note	ITEM NUMBER	Web Site: www.EnergyEdgeForm.com	Detail A	Detail B	Detail C	Detail D
		LINE ITEM DESCRIPTION	Traditional "Non-Insulated" Edge JUNTS	NEW EnergyEdge INSTALLATION JUNTS	Equivalent Protected Edge Detail JUNTS	"FLOATING" Slab Isolation Detail JUNTS
a	1	EnergyEdge FORM MATERIAL		\$ 4.50 LF		
e	2	REBAR MATERIAL (Perimeter)	\$ 0.35 LF	\$ 0.35 LF	\$ 0.35 LF	\$ 0.35 LF
b	3	LUMBER MATERIAL	\$ 1.65 LF	\$ 0.41 LF	\$ 1.65 LF	\$ 2.48 LF
	4	EXTERIOR INSULATION @ FOOTING		\$ 1.35 LF	\$ 1.35 LF	
	5	INTERIOR INSULATION @ FOOTING	\$ 1.35 LF			\$ 1.35 LF
	6	RETURN & HIGH-DENSITY INSULATION	\$ 1.35 LF			\$ 1.35 LF
c	7a	ADDITIONAL FLASHING MATERIALS			\$ 0.73 LF	
c	7b	LABOR TO INSTALL FLASHING			\$ 1.36 LF	
b	8A	INSTALLATION COST	\$ 3.77 LF	\$ 3.77 LF	\$ 3.77 LF	\$ 5.66 LF
b	8B	INSTALLATION OF EDGE INSULATION	\$ 0.25 LF		\$ 0.25 LF	
d	8C	STRIP FORM MATERIAL	\$ 0.32 LF	\$ 0.05 LF	\$ 0.32 LF	\$ 0.48 LF
b	8D	ADDITIONAL LABOR COST (FLASHING)			\$ 1.36 LF	
g	8E	DISPOSAL / LANDFILL (Est. in Cubic Feet)	\$ 0.23 CF	\$ 0.08 CF	\$ 0.23 CF	\$ 0.45 CF
f	9	FORM OIL RELEASE CHEMICALS	\$ 0.10 LF		\$ 0.10 LF	\$ 0.10 LF
	10	CONCRETE MATERIAL SAVINGS		\$ (0.05) LF	\$ (0.05) LF	\$ (0.05) LF
			\$ 9.37 LF	\$ 10.46 LF	\$ 11.42 LF	\$ 12.16 LF

PERCENTAGE INCREASE ABOVE STANDARD UNINSULATED CONCRETE EDGE NOT MEETING ASHRAE 90.1 STANDARDS

BASE COST OF SLAB FORMING LABOR AND MATERIALS

12%

more than an uninsulated slab

22%

more than an uninsulated slab

30%

more than an uninsulated slab

APPROXIMATE INCREASE IN COST PER LINEAL FOOT OF SLAB / SYSTEM

\$ 1.09 LF

\$ 2.05 LF

\$ 2.80 LF

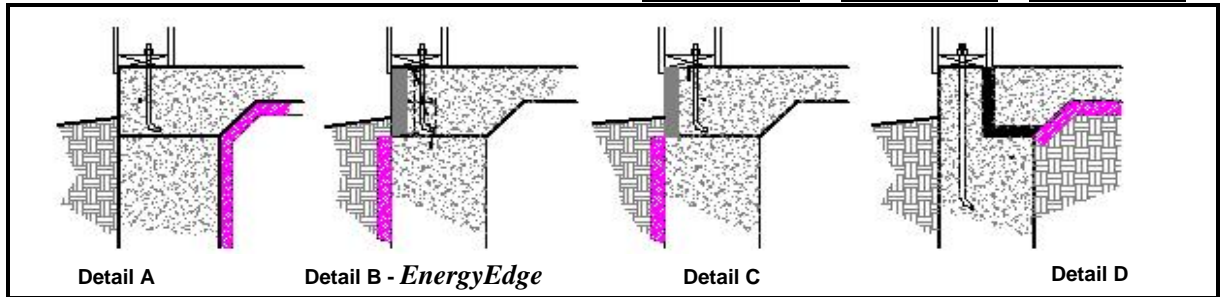

ENERGY PERFORMANCE AND ESTIMATED PAYBACK FOR EACH SYSTEM

With the proper location of insulation at the exposed edge of slab construction meeting ASHRAE 90.1 & IECC 2006 Energy Performance Standards, it is reasonable to expect an 8% reduction in heat loss in a zone 4 & 5 environment. This efficiency will increase in zones 6 thru 8

8%

Details B, C & D

If your monthly heating bill is **\$ 150** by providing insulation to the slab edge you save...

\$ 12.00

* Assumes a building size of approximately 2400 sq.ft. (Approximately 200 lf of slab edge).

SAVINGS / MONTH *

EnergyEdge

21

MONTHS TO RECOVER COST

Detail C

39

MONTHS TO RECOVER COST

Detail D

54

MONTH TO RECOVER COST

Notes

- a EE Pricing of basic EE8fb rail and use of 10 EE8sb braces per 12' length of material. No transition members are included.
 - b NCE Concrete Formwork section for 2X8 Edge Forming material and labor estimates.
 - c NCE Based on material and installation cost of 2" X 8", galvanized "Termite Shield" Flashing for Slab Edge.
 - d NCE Form Stripping includes cost of one labor to remove, clean and stack material on job site.
 - e EE Perimeter Rebar, only the EnergyEdge System includes a standard "chair support", this would be an additional cost with all other assemblies.
 - f NCE Include use of form oil which is not necessary with the use of EnergyEdge Systems.
 - g NCE Based on cost data used in other building material assembly comparison models. Cost of disposal \$1.50 per cubic foot of waste. Assumes 2X8 material plus miscellaneous bracing material, .12 cu.ft. / lf of 2X8 material.
- Source
NCE 2006 National Construction Estimator - Labor and Material cost for Contractors with their own crews, O&H are not included.
EE EnergyEdge material and assembly estimates. Based on 2007 pricing.